

Assembly Instructions

BIFOLD FUTON FRAME WINSTON TRAY

Instructions apply to all sizes:

- Full/Double
- Queen

1PA-0304

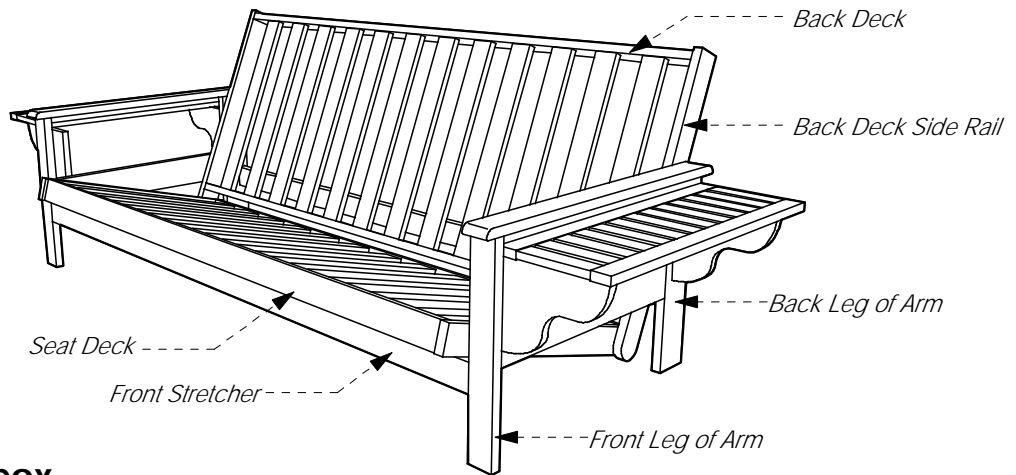

1A Parts in this box.

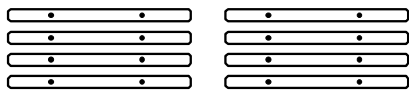

Slat Supports x 4

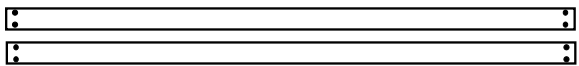

Stretchers x 2

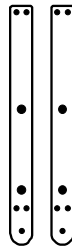

Side Rails x 2

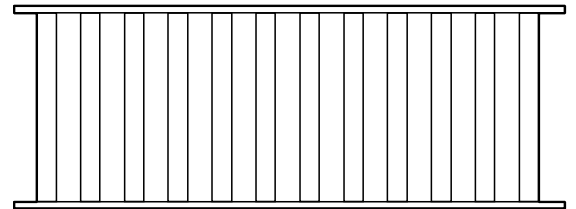

Back Deck x 1

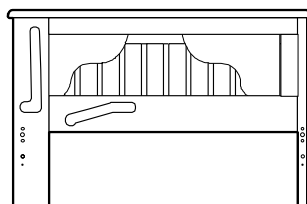
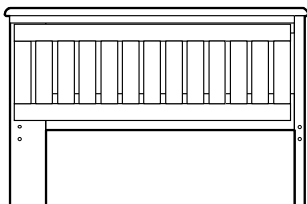

Arms x 2

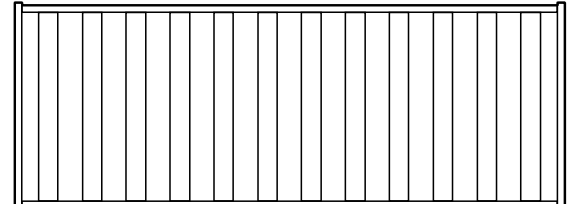

Seat Deck x 1

1B Hardware in this box.



16mm Bolts x 4
For the Stretcher Brackets.



30mm Bolts x 16
For the Slats Supports.



60mm Bolts x 12
For the Side Rails and Back Leg.



100mm Bolts x 4
For the Front Leg.

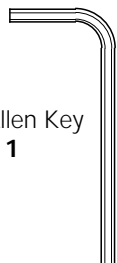

Allen Key
x 1

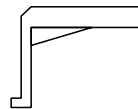

Stretcher Brackets
x 4

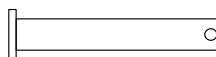

Clevis Pins
x 2



Barrel Nuts
x 16



Wood Button
x 4



Locking Pins
x 2



Washers
x 2

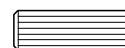

Wooden Dowel
x 4

1C Queen size only: Extra Parts.

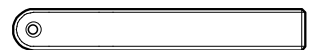

Small Leg x 2



50mm Bolts x 2

2A Fasten Stretcher Brackets to Arm.

- Insert the Stretcher Bracket Cleat into the hole provided.
- IMPORTANT:** Don't fully tighten Bracket until Stretchers are all in place for easy alignment.
- Each arm requires two brackets, front and back.

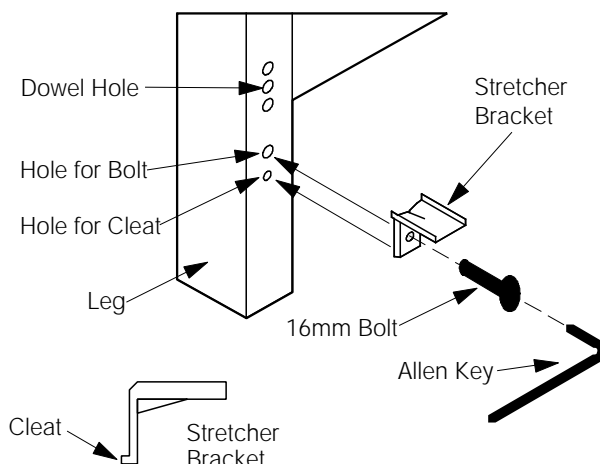

2B Fit Wooden Dowels

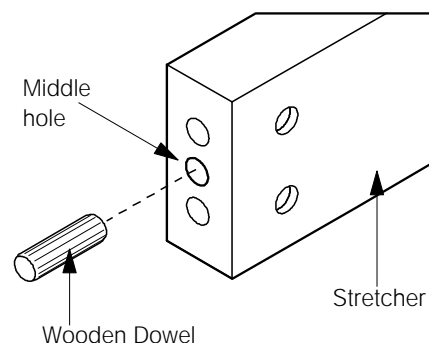

Tap dowels all the way into the middle hole at each end of the Stretchers.

2C Attach Arms to Stretchers.

Using Bolts and Barrel Nuts provided with the Arms, attach the Arms **LOOSELY** to the Stretchers as shown..

It is important that these bolts are left **LOOSE!**

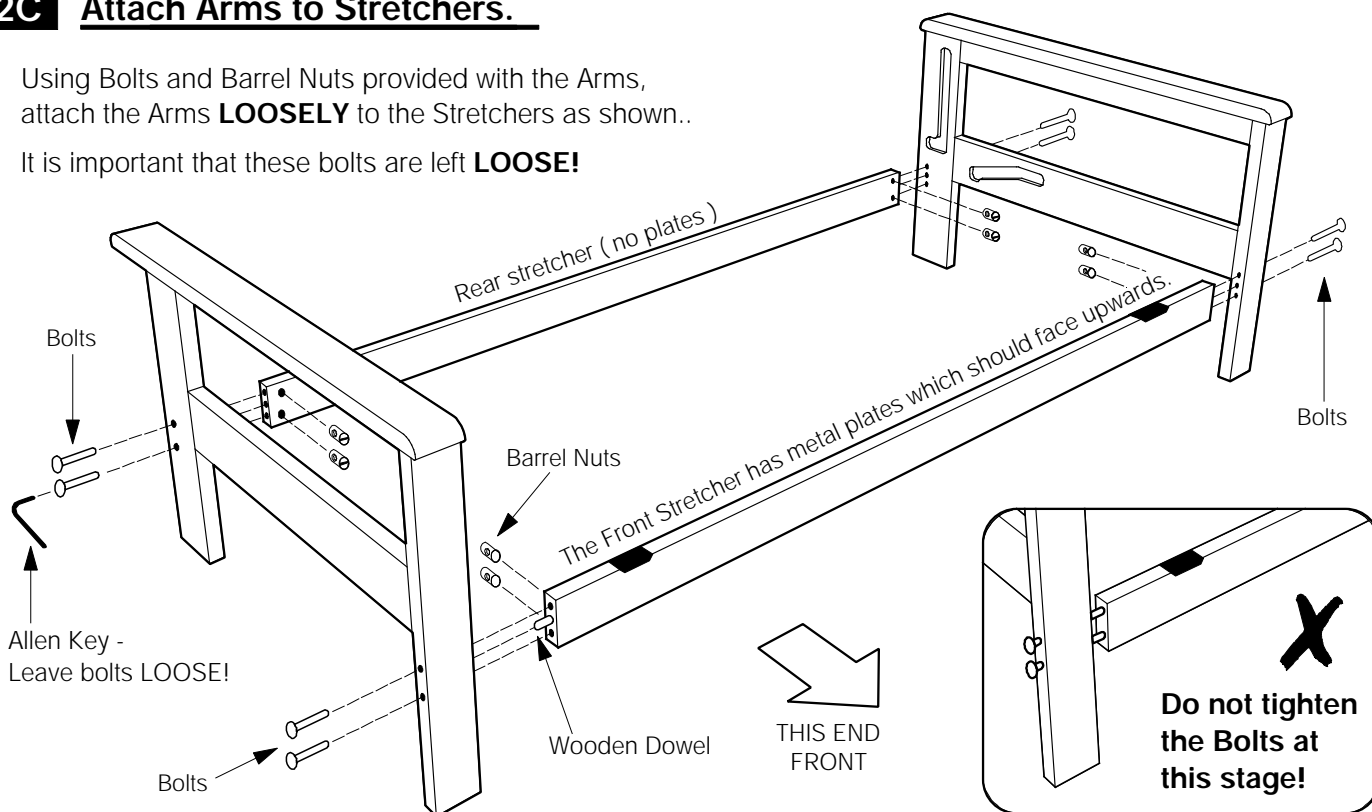

BOLT AND BARREL NUT ASSEMBLY SYSTEM

- ✓ Insert Barrel Nuts as shown using a screwdriver. This will help you position the Nut in line with the Bolt.
- ✓ Do not force the Bolt as you may strip the thread. Be sure the thread is properly started.

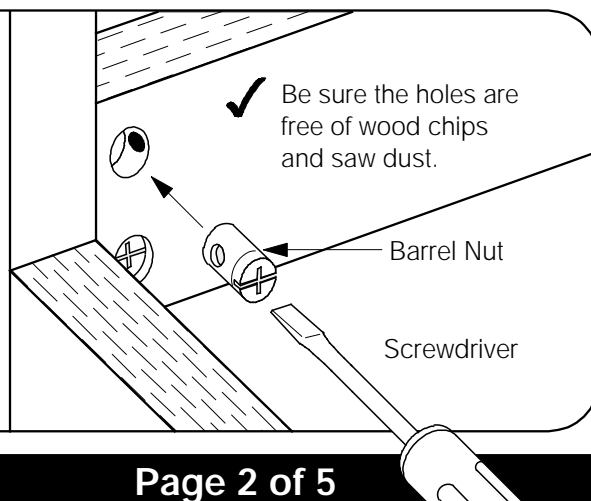
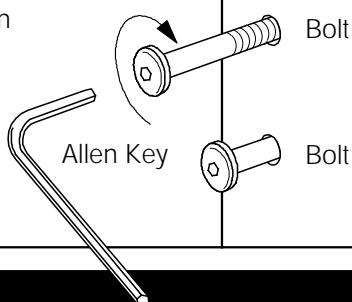

3A Attach the Side Rails to the Back Deck.

Using the Bolts and Barrel Nuts packed in this box, attach the Back Side Rails to the Back Deck.

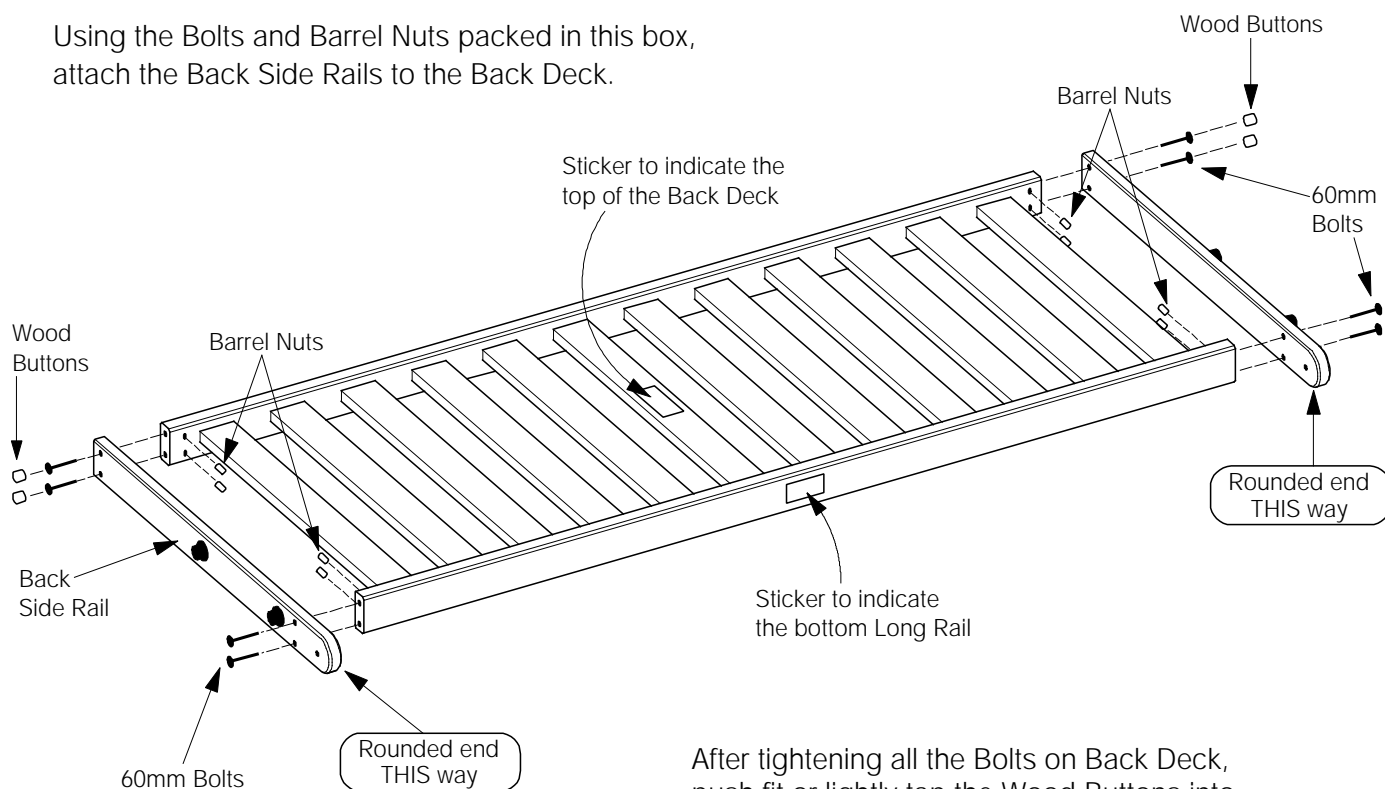

After tightening all the Bolts on Back Deck, push fit or lightly tap the Wood Buttons into the holes as shown.

3B Seat Deck: The Side Rails are preassembled.

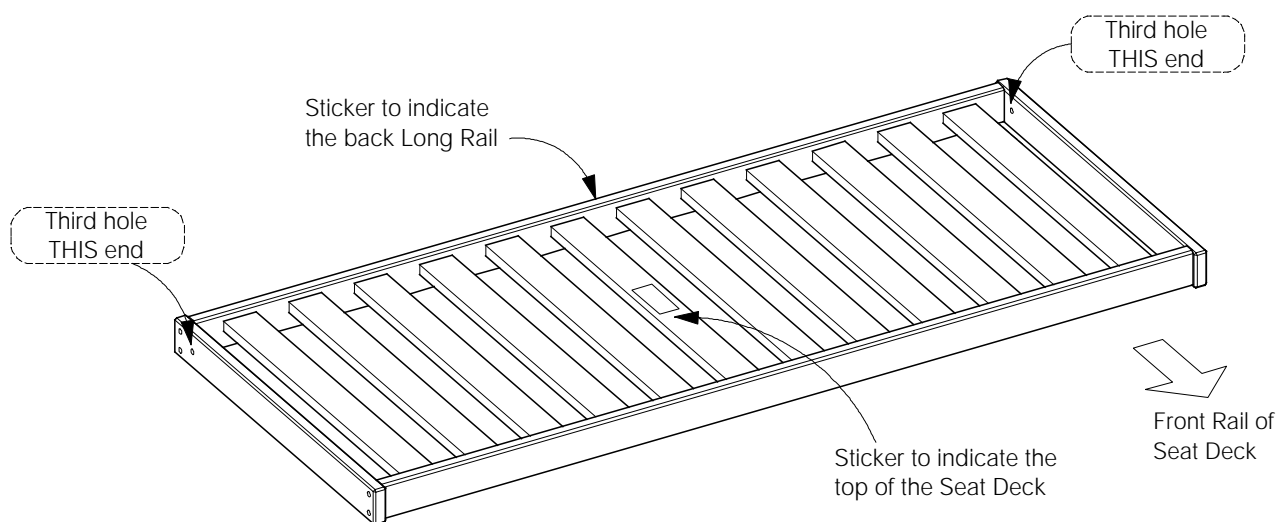

✓ The Seat Rails are already assembled to the Seat Deck.

Helpful Tip:

Mattress will sit on this surface (Surface with Sticker Indication)

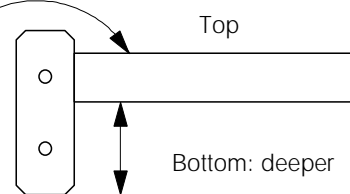

4A Attach the Slat Supports to the Back Deck

The 30mm Bolts from this box, screw into the insert nuts provided on the Slat Supports.

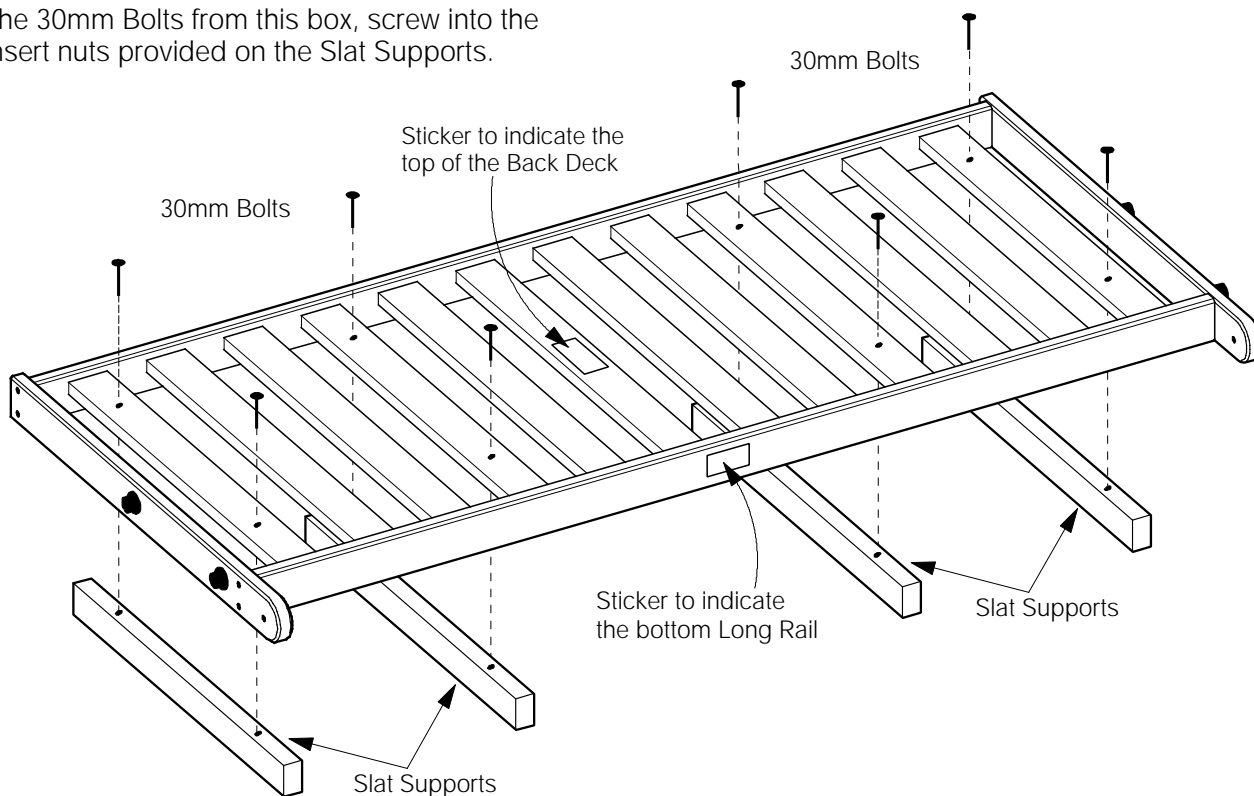

4B Attach the Slat Supports to the Seat Deck

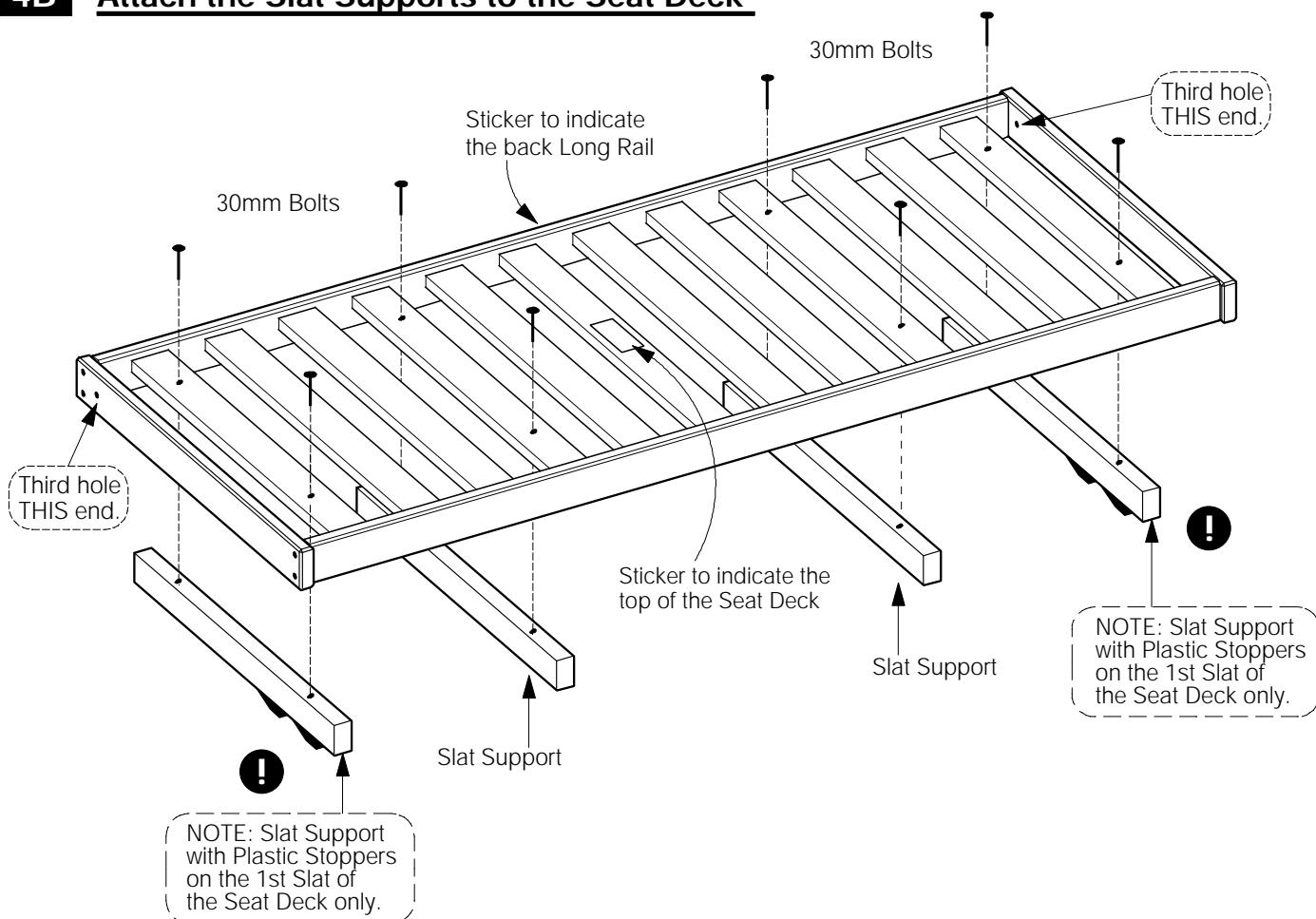

5A Fit Back Deck into Position.

- A. Insert the Back Deck lying flat. Insert one end first, then gently lower the other end into position.

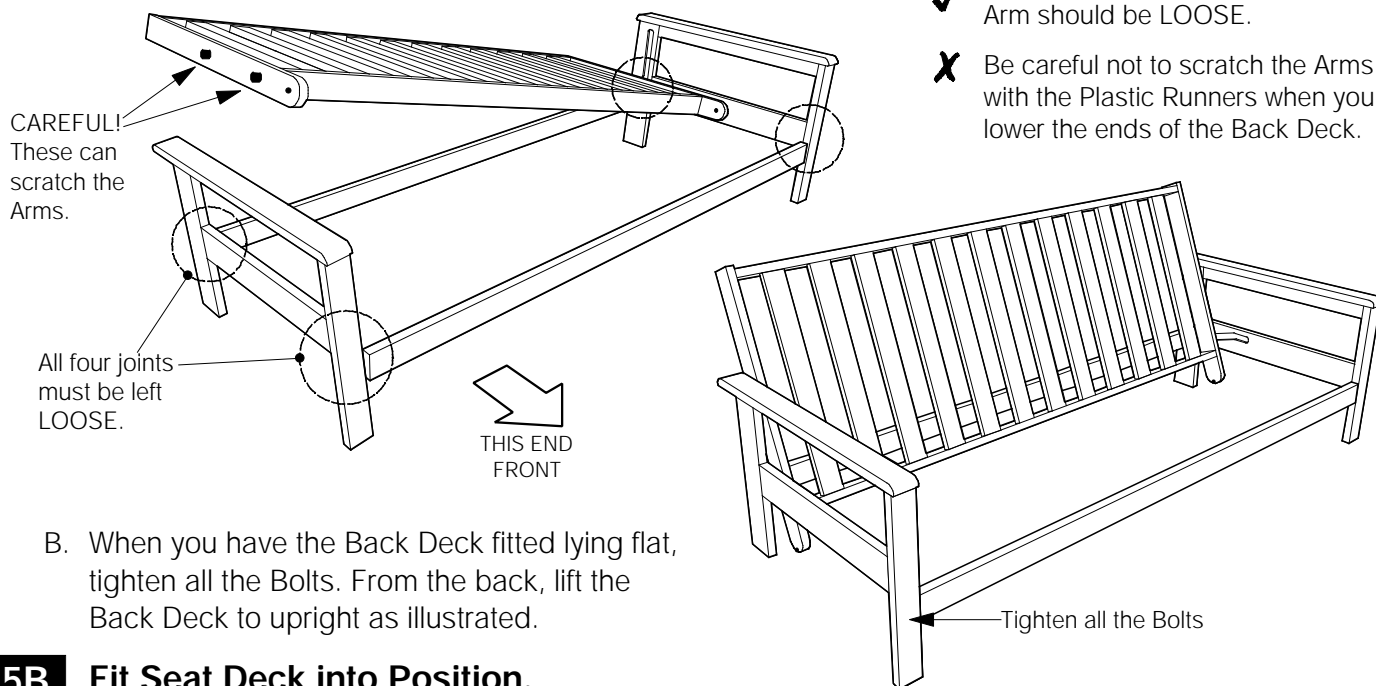

Your arm style may vary

- ✓ This step can be tricky - it is best done with two people
- ✓ Remember that the Bolts on the Arm should be LOOSE.
- ✗ Be careful not to scratch the Arms with the Plastic Runners when you lower the ends of the Back Deck.

- B. When you have the Back Deck fitted lying flat, tighten all the Bolts. From the back, lift the Back Deck to upright as illustrated.

5B Fit Seat Deck into Position.

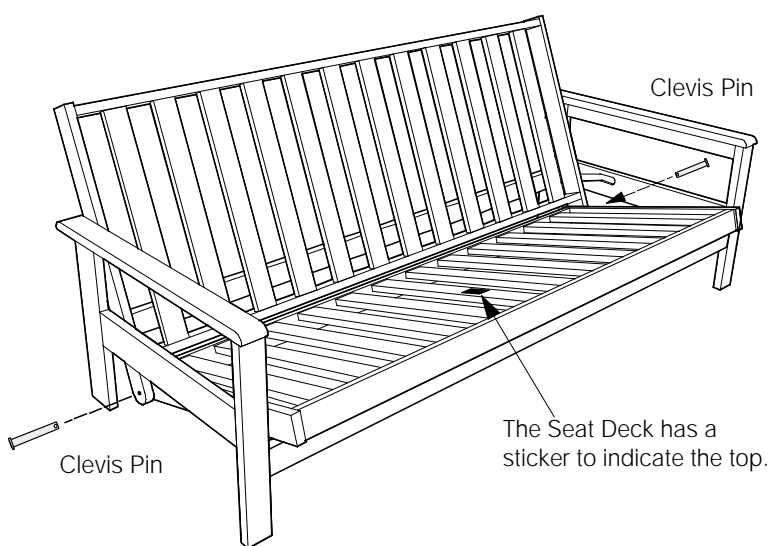

Fit the seat deck between the Arms and into the Back Deck as shown. Use the Clevis Pins to connect the two decks. Secure with a Washer and Locking Pin.

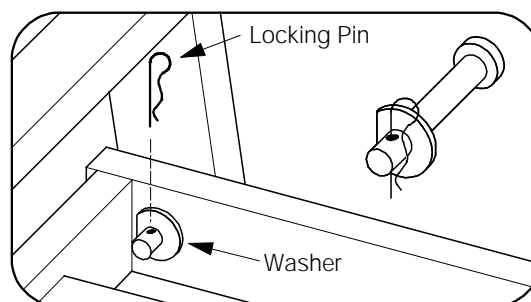

5C Queen size only: Attach short legs.

